

Kuell

Our innovative,
practical & stylish lint remover



CORDLESS
LINT REMOVER
INSTRUCTION MANUAL



www.kuell.in

Safety

Please retain instructions for future reference.

- Carefully read this manual before use, and keep for future reference.
- This appliance is only connects to USB port.
- During charging, the appliance will not work.
- Avoid recharging and storing in damp places.
- Before use, check that the mesh cover is tight, otherwise the appliance will not be able to work properly.
- It is prohibited to use the appliance on clothes that being worn, as this may cause damage to the body or clothing.
- Use only for trimming clothing hair.
- Don't disassemble the appliance.
- Do not let children play with this appliance.
- This appliance can be used by children aged from 8 years and above and persons with reduced physical, sensory or mental capabilities or lack of experience and knowledge if they have been given supervision or instruction concerning use of the appliance in a safe environment and understand the hazards involved. Children must never play with this appliance. Cleaning and user maintenance shall not be done by children unless they are older than 8 and supervised.
- Do not open and take out blade.
- Do not use the appliance if it has obvious damage or if the blade's components or outside mesh have been damaged.
- Do not open and use if the appliance is charging, or during cleaning and maintenance.
- Keep your fingers and hands away from the blade during cleaning and maintenance.

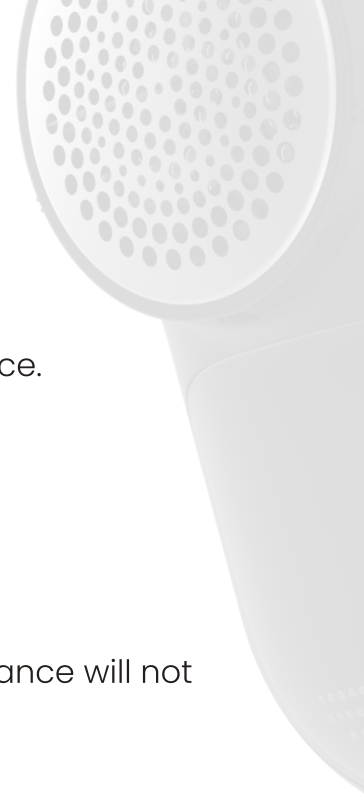

Battery Safety

- The supply terminals are not to be short-circuited.
- In the event of a battery and cell leaking, do not allow the liquid to come in contact with the skin or eyes. If contact has been made, wash the affected area with copious amounts of water and seek medical advice.
- Do not use any cell or battery which is not designed for use with the product.
- Secondary cells and batteries need to be charged before use.
- After extended periods of storage, it may be necessary to charge and discharge the cells or batteries several times to obtain maximum performance.
- Keep batteries out of the reach of children.
- Do not dispose of batteries in a fire.
- Do not dismantle, open or shred secondary cells or batteries.
- Do not expose cells or batteries to heat or fire.
- Do not crush, puncture, dismantle or otherwise damage batteries.
- Do not store above 60 °C.
- Avoid storage in direct sunlight.
- Do not subject batteries to mechanical shock.
- Do not dispose of exhausted batteries in household waste.
- Once the batteries have been exhausted, dispose of the unit at a local recycling station. Contact the local government offices for further details.
- This product is fitted with 2 x 1.2 V 600 mAh Ni-MH rechargeable batteries (non-removable).

Care and Maintenance

Always switch off and unplug the lint remover from the mains power supply before attempting any cleaning or maintenance.

STEP 1:

Wipe the lint remover with a soft, damp cloth and dry thoroughly.

Do not immerse the lint remover in water or any other liquid.

STEP 2:

Check that the blades are free from debris (e.g., hair), as this could affect the performance of the lint remover.

Note:

The lint container should be emptied and cleaned after each use.

Description of Parts

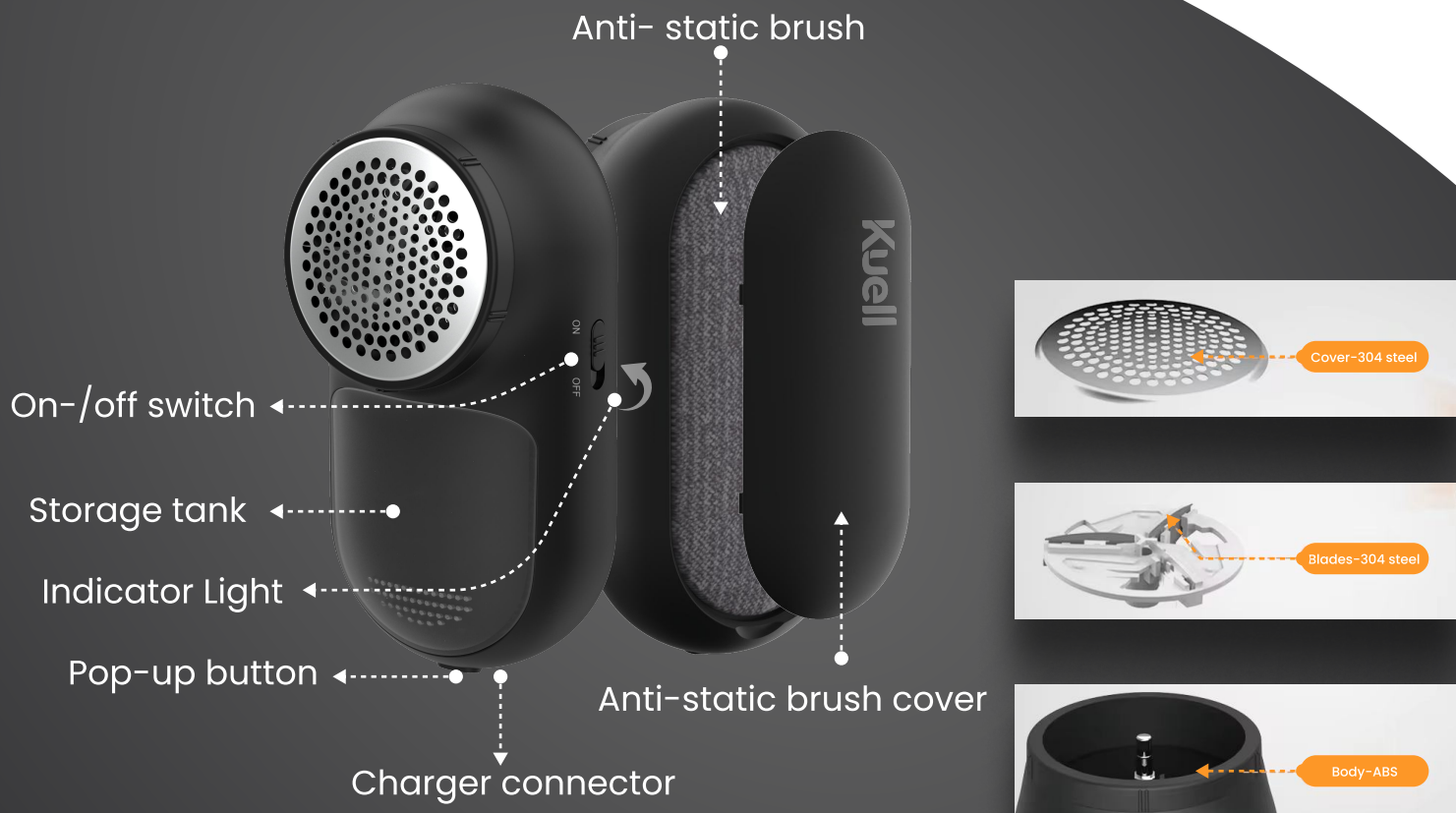

Charging the Cordless Lint Remover

Before first use, the lint remover must be charged for approx. 3-4 hours. Subsequent charging times will take max. 8 hours, dependent on use.

- STEP 1:** Connect the micro USB end of the micro USB charging cable (included) into the micro USB charging port on the lint remover.
- STEP 2:** Plug the USB end of the micro USB charging cable into a compatible USB charging port; the charging indicator light will flash to indicate that the battery is charging. Once the battery is fully charged, the charging indicator light will stop flashing and remain illuminated.

Note: Whilst charging, the lint remover may become warm.

Caution: Exercise caution when charging the lint remover; it must be stood upright on a dry, stable surface, away from other appliances.

Warning: Do not leave the lint remover unattended whilst it is charging. If the battery is exhausted, the charging indicator light will flash when attempting to turn on the lint remover. It is recommended to charge the lint remover slightly before storage. This will help to prolong the life of the battery.

Using the Cordless Lint Remover

STEP 1: Remove the protection cap and place the garment to be treated onto a flat, even and clean surface. Straighten the garment to minimise creases.

STEP 3: Switch the lint remover on by pressing the power button.

STEP 2: Guide the lint remover over the garment using repeated, light, circular movements across the surface of the fabric

STEP 4: Switch off the lint remover by pressing the power button and replace the protection cap.



Note: The lint remover will switch off automatically when the blade cover is unscrewed.

Warning: To avoid damage to fabrics always use the lint remover on a flat surface.

Do not use the lint remover on buttons, embroidery, zips, loose threads or stitches.

Do not apply too much pressure during use to avoid damaging fabric.

Cleaning the Cordless Lint Remover

- STEP 1:** Connect the micro USB end of the micro USB charging cable (included) into the micro USB charging port on the lint remover.
- STEP 2:** Remove the blade cover by unscrewing it in an anticlockwise direction.
- STEP 3:** Carefully remove the blades; use the cleaning brush to scrape off fluff and lint remnants.
- STEP 4:** Reattach the blades by pushing back onto the lint remover main body until secure. Replace the blade cover by rotating in a clockwise direction until secure.
- STEP 5:** Attach the lint container by screwing back onto the main unit in a clockwise direction.
- STEP 6:** Replace the protection cap.

Warning: The blades are delicate and sharp, exercise care during cleaning. Keep fingers and hands away from the blades during cleaning and maintenance.

Storage

Check that the lint remover is cool, clean and dry before storing in a cool, dry place.

Troubleshooting

Symptom	Cause	Solution
The lint remover will not turn on	The lint remover has run out of charge. The lint container or blade cover is not secured correctly to the lint remover main body	Charge the lint remover following the instructions in the section entitled 'Charging the Cordless Lint Remover' Reattach the lint container or blade cover to the lint remover main body by rotating in a clockwise direction until secure.
The lint remover is not removing lint from fabric.	Lint is wrapped around the blades.	Clean the blades following the instructions in the section entitled 'Cleaning the Cordless Lint Remover'.



Kuell Trademark.

All rights reserved.

Hyderabad, Telangana, India

If your Kuell product does not arrive in satisfactory condition, please contact our Customer Services Department at www.kuell.in.

Make sure to have your delivery note available, as details from it will be required.

If you wish to return this product, please return it to the retailer from where it was purchased, along with your receipt (subject to their terms and conditions).

Guarantee

All new Kuell products come with a manufacturer's guarantee. The guarantee period is 1 year from the date of purchase, provided reasonable proof of purchase is available. This guarantee applies only when the product has been used as intended for domestic purposes. Misuse or dismantling of the product will void the guarantee.

Under this guarantee, we will repair or replace any defective parts free of charge. If an exact replacement is not available, a similar product will be offered, or a refund may be issued. Damages resulting from regular wear and tear or consumables such as plugs and fuses are not covered under this guarantee.

Please note that the terms and conditions of this guarantee may be updated occasionally. We recommend checking them each time you visit our website.

This guarantee does not affect your statutory rights.

The crossed out wheellie bin symbol on this item indicates that this appliance needs to be disposed of in an environmentally friendly way when it becomes of no further use or has worn out. Contact your local authority for details of where to take the item for recycling.

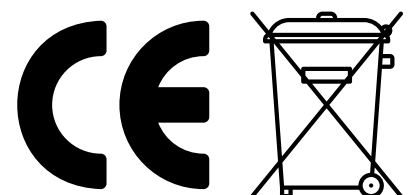

Kuell



1 YEAR
GUARANTEE*

*To be eligible for the extended guarantee,
go to <https://kuell.in> and register your product
within 30 days of purchase

Rechargeable batteries are not included in the extended manufacturer's
guarantee (after the first 12 months).

Find us on:



www.instagram.com/kuell.in/



www.youtube.com/@Kuell_In

ADDITIONAL FEATURE



PRODUCT SIZE



Kuell



Kuell Retail

Hyderabad, India

www.kuell.in

In case of any issues, feel free to reach out to us:

Call us at: +91 9000 2343 69

Mail us at: support@kuell.in

Kuell Trademark. All rights reserved.